

# Instruction

---

## M220 Product Instruction

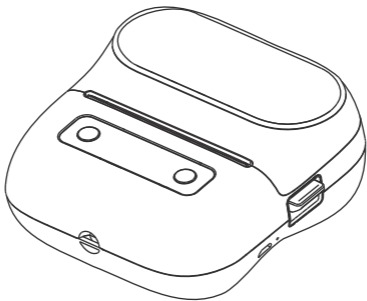

Please read this instruction book carefully before operating the product.

# 01. Packing List

---



Printer\*1



Product instruction\*1

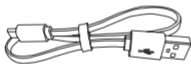

Charging line\*1

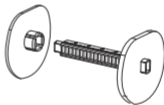

Removable gearadjustment board\*1 ( installed in the printer)



**NOTE**

• The number of paper rolls in the list is subject to the actual shipment.

## 02. Product Specifications



---

Name	Multifunctional Portable Label Maker
Model	M220
Print technology	Thermal printing
Effective printing width	20-75mm
Supported consumables	Pre-cut paper,black mark paper,continuous paper
Consumable specifications	80mm XΦ 50mm(Max width X Max diameter)
Print speed	30-50mm/s(switchable,level1-5)
Printing density	Switchable,level1-15
Print resolution	203dpi
Print head service life	50KM
Communication interface	Bluetooth 4.2
	Micro USB
Product size	125*119*63.5mm (4.92*4.68*2.5in)
Power input	5V==2A
Power supply method	Micro USB
	Lithium battery
Supported operating system	Android
	iOS
Instruction set	ESC/POS
Bar code	1D bar code & 2D bar code
Working environment	5°C~50°C
Storage environment	-20°C~60°C
Working humidity	20%~85%
Storage humidity	2%~95%(Non condensation)

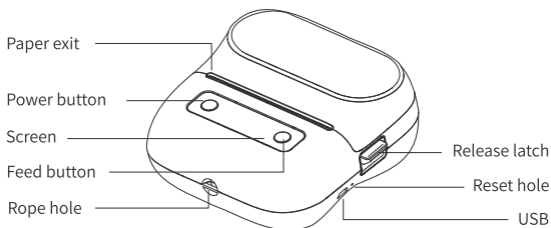
## 03. Product Appearance Introduction



### Button function introduction

Diagram	Button	Operating	Features
	Power button	Long press 3s	Power on/off
		Continuous click	Switchable home menu
	Feed button	Continuous click	When setting the menu, click to confirm the sub-menu option (toggle sub-menu option)
			In standby, stand-alone paper feeds one sheet

## 04. Component Description

---

### Display settings home menu

Options	Parameter
Language	English, Spanish, French
Print density	1(weakest),2,3,4(weak),5,6(Normal),7,8,9,10(Dark),11,12,13,14,15(Darkest)
Print speed	1(Slowest),2(Slow),3(Normal),4(Fast),5 (Fastest)
Paper gap type	Continuous,Gap,Black mark
Auto power OFF	NO Close,5 Minutes,15 Minutes,30 Minutes,1 Hour,2 Hour,4 Hour,8 Hour,24 Hour
Restore to Factory Settings	Press power button to restore
Firmware version	Display Firmware version
Device address	Display device address

### Screen hint

Content	State
Shutting down	Battery lower than 1%
Printing ...	Printing regularly
Feeding ...	Press Feed button
High temperature please wait	Print head is overheated
No Paper ...	No paper in the bin or paper is installed incorrectly
Paper cover is opened	The paper cover is opened

## 05. Printer Paper Roll Installation

① Long press the power button for 3s.

② Slide the release latch down to open paper compartment cover.

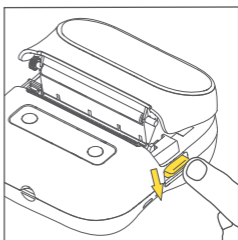
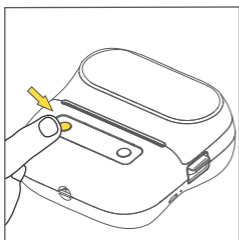

③ Take out the label paper mounting bracket in the paper compartment.

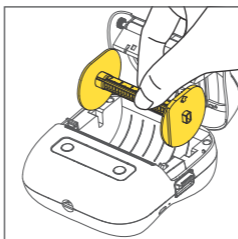

④ Remove the left baffle, put in the label paper roll (label printing side down), and push the left baffle to right.

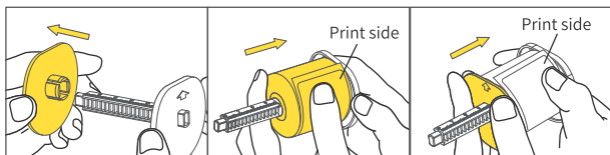

⑤ Align the installed label roll holder with the card slots on both sides, and put it into the paper compartment.

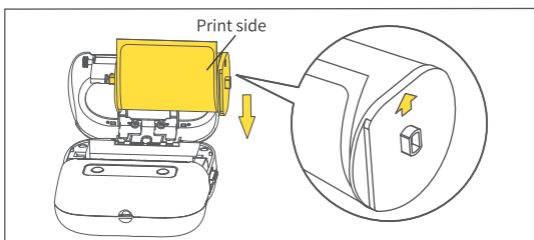

⑥ Pull out part of the paper (approximately 15mm above the paper exit), and close the paper compartment cover.

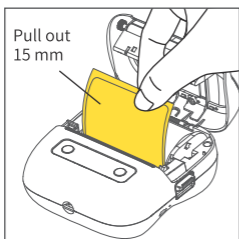

⑦ The printer feeds paper automatically to position the gap of label paper, and then the paper roll installation is complete.

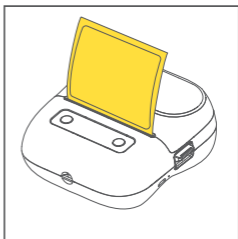

• After the first operation or each time you replace the consumables, the printer will automatically feed the paper, so that the printer can position the label to avoid there will be incomplete printing, missing, non-aligned, etc.

## 06. App Download Method

---

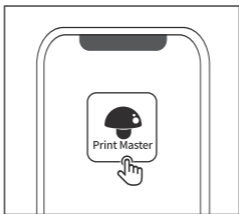

**NOTE**

- This product needs to be connected to the printer in the App.
- Due to the requirements of mobile phone system, the Android mobile phone will use the user's geographic location when connecting, so that the user needs to turn on the GPS and confirm the authorization.

### Method I:

Please use your mobile phone to scan the QR code to download the App.



### Method II:

Search "Print Master" to download App.



## 07. Printer Connection

- ① Turn on GPS (Android mobile phone only).

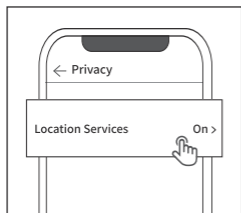

- ② Open the App.



- ③ Click to search **Connect now** for the device.

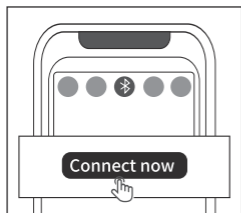

- ④ Connect immediately.

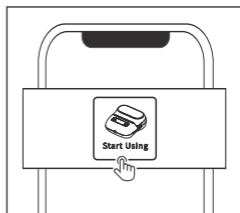

**NOTE**

- When connecting device in the App, please make sure that your printer is turned on and Bluetooth of your mobile phone is turned on.
- Due to the requirements of mobile phone system, the Android mobile phone will use the user's geographic location when connecting, so that the user needs to turn on the GPS and confirm the authorization.



## 08. Confirm the Label Size

---

### Method I:

Check the label paper packaging.  
Please refer to the actual size used.

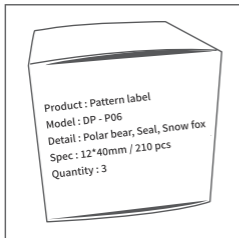

### Method II:

Use a ruler to measure.

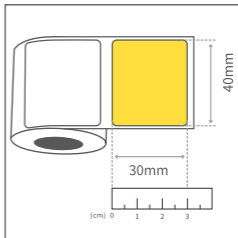

## 09. Printing Guide—New Label

---

- ① After clicking "New ", customize the label size and paper type.

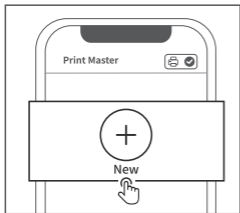

- ② Customize the label size.

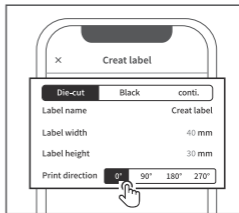

- ③ Click "(T)" to input text.

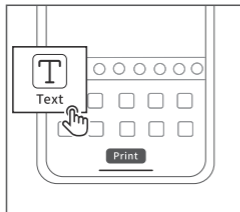

- ④ After editing, click to "Print".

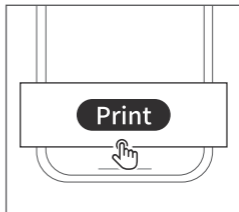

## 09. Printing Guide—Select the "Label "Template

① Click "Label".



② Select the label paper template.

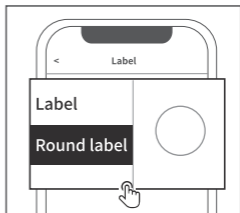

③ Click "(T)" to input text.

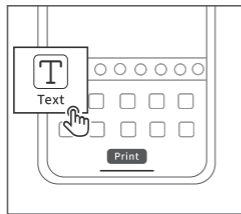

④ After editing, click to "Print".

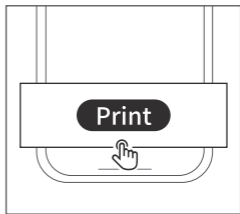

• If the matching template is not selected, there will be undesirable situations such as half printed.

## 09. Printing Guide—Edit function description

### Shortcut keys

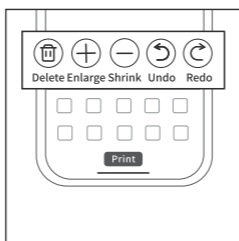

### Editing function

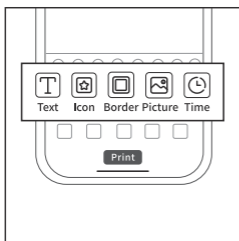

### Editing function

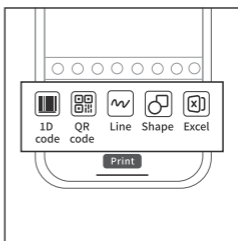

• App functions will be updated with new functions in irregular, please refer to the actual function.

Functions	Description
T	Click to insert text. User can edit the text size, typesetting and select various fonts, etc.
★	Icon function, click to insert all kinds of cute icons.
□	Click Border Function, and choose various cute borders to decorate your label.
🖼️	Click to insert the picture you want to edit and print.
🕒	Insert date and specific time.
📄	Click to scan the code to identify. It can quickly identify the text content in the QR Code.
▮	Click to insert a one-dimensional code. Enter the information to be edited, then a one-dimensional code can be automatically generated, and the layout can be adjusted.
QR	Click to insert a QR code. Enter the information to be edited, then a QR code can be automatically generated, and the layout can be adjusted.
~	Insert a line. User can choose a dashed line or a solid line.
○ □	Click to insert round or square shapes.
📊	Support table import, therefore quickly generating a list that needs to be printed.
🔍	Click to recognize text in the picture.
🌱	One-click editing/printing of more scene label templates.

## 10. How to Deal with Common Problems

Serial number	Common problem	Treatment
1	With paper fed into the bin, still no paper is detected on the screen. What's the matter?	Referring to the instructions, check whether the paper is in place on the right side of the printer. Pull out the paper a bit from the outlet, allowing it in between the upper and lower paper sensors, and close the bin cover.
2	Long-press the power key, what if no response?	The printer may be in power failure. Restart it after charging for half an hour.
3	What if automatic shutdown of a printer?	(1) Check whether the App has set the automatic shutdown time; (2) If the power is too low, it will automatically shut down in need of a timely charge.
4	What if the printer refuses to charge?	(1) Please charge for at least half an hour; (2) Manual reset. There is a reset plughole (reset hole) beside the printer charging port. Just press for 1-2 seconds with a pin and let go; (3) Please check whether the charger uses 5V-1A or 5V-2A for charging; (4) Replace the charger or move to another outlet; (5) In case the above method still fails, please contact the local dealer for replacement.
5	What if the printer refuses to charge?	(1) Press the power key to cancel; (2) Manual reset. There is a reset plughole (reset hole) beside the printer charging port. Just press for 1-2 seconds with a pin and let go.
6	What if the paper is blank after printing?	(1) The paper roll is installed reversely. Arrange the printing paper in the other direction, making sure that the correct printing side is facing down, and keep it to the right side. (2) If paper is blank during the printing gap, please check whether the printer display menu has correctly selected "label paper".
7	Fuzzy printed content	(1) Check whether the label roll is in the storage period or whether there are foreign matters, clean or replace another; (2) According to the instructions, wipe the printing area with an alcohol swab to ensure that there is no dirt on the print head.
8	Indirect skip or incomplete printing content occurs	(1) Cleanse the printer thermistor and paper outlet according to the instructions; (2) Reinstall the paper roll bracket once, and manually press the paper feeding key once to allow the printer to recognize the paper gap position. (3) Check whether the paper size and software print template match.
9	How to solve the problem that the printer does not run smoothly or feeding failure in the process of paper feeding or printing?	(1) The paper roll bracket is too tight or stuck. Generally, it is about 1mm of the Appropriate gap between the roll and the baffles on both sides, which can ensure smooth feeding without paper jam. (2) According to the instructions, wipe the printing area and paper outlet area of the printer with an alcohol swab, touch the printing area with your hand to check no stickiness, and then try to print.
10	What if multiple mobile phones are simultaneously connected, but can't be functioning?	(1) A printer can function only connected to one mobile phone, rather than multiple ones at the same time. (2) When connected to another phone, please first disconnect the connected one.

## 11. Warranty Description

---

Thank you for choosing the label printer products produced by our company.

- ① We will provide customers with reliable "replacement/return" support during the one-year warranty period from the date of purchase;
- ② Please keep the warranty card in a safe place so that you can read it when needed.

This manual has been carefully checked. If there are printing errors or misunderstandings in the content, please consult customer service.

NOTE: If the supporting software is updated, it will be compiled into the new version of the manual without notice.

## 11. FCC Caution

---

This device complies with part 15 of the FCC Rules. Operation is subject to the following two conditions:

(1) This device may not cause harmful interference, and (2) this device must accept any interference received, including interference that may cause undesired operation.

Any Changes or modifications not expressly approved by the party responsible for compliance could void the user's authority to operate the equipment.

Note: This equipment has been tested and found to comply with the limits for a Class B digital device, pursuant to part 15 of the FCC Rules. These limits are designed to provide reasonable protection against harmful interference in a residential installation. This equipment generates uses and can radiate radio frequency energy and, if not installed and used in accordance with the instructions, may cause harmful interference to radio communications. However, there is no guarantee that interference will not occur in a particular installation. If this equipment does cause harmful interference to radio or television reception, which can be determined by turning the equipment off and on, the user is encouraged to try to correct the interference by one or more of the following measures:

- Reorient or relocate the receiving antenna.

- Increase the separation between the equipment and receiver.

- Connect the equipment into an outlet on a circuit different from that to which the receiver is connected.

- Consult the dealer or an experienced radio/TV technician for help.

\*RF warning for Portable device:

The device has been evaluated to meet general RF exposure requirement.

The device can be used in portable exposure condition without restriction.

## 12. Warranty/Maintenance Card

---

Replace

Return

<b>User Information</b>	Name: <span style="float: right;">Gender:</span> Phone:
	Address:
<b>Product Information</b>	Date of purchase:
	Product order number:
	Product serial number:
<b>Reason for Return</b> ( Replace / Repair / Request Maintenance )	Fault description:



Thank you for choosing our products!