

KEY NINJA®

LEGEND + INSTRUCTIONS

A Screws



B Front Plate

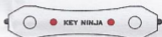

C Back Plate



D Posts



E Spacers



F "S" Hook



MAINTENANCE

To replace batteries, remove piece **B** and unscrew two screws on bottom to separate top and bottom pieces.

If posts get stuck in the screws, use pliers to hold posts **D** and unscrew with screwdriver.

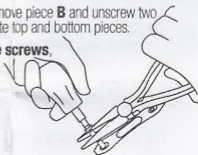

- 1 Remove pieces **A** and **B** and set aside



- 2 Add keys to posts on piece **C**, cut side facing in



- 3 Add extenders **D** as needed for more keys



- 4 Once all keys have been added, use black spacers **E** to ensure there is an even platform before replacing **B**

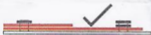

- 5 Replace **B**



- 6 Tighten **A** screws using a coin, card or your Wallet Ninja



For more information visit www.keyninja.com